

17
18 AND 19

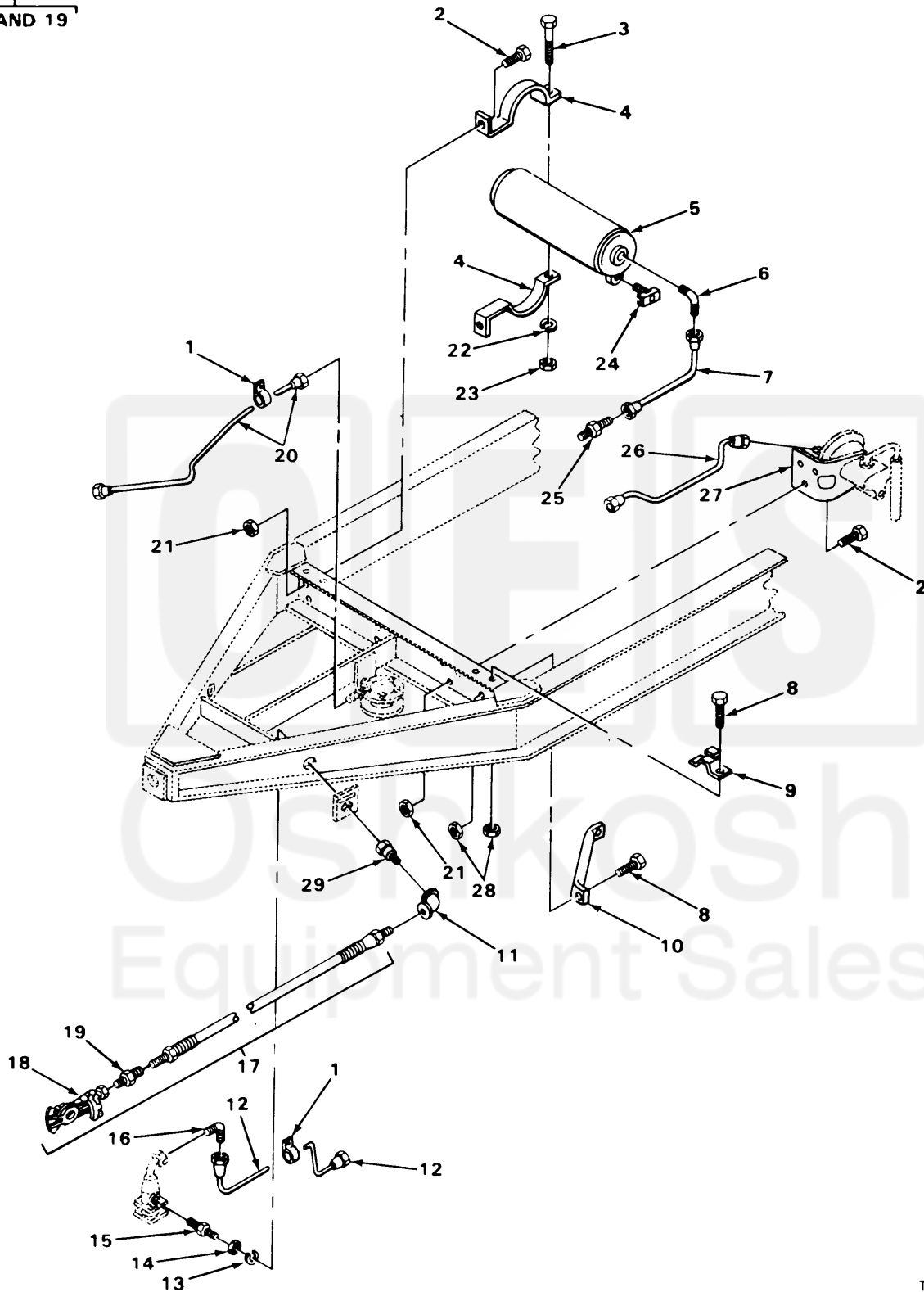

TA222963

FIGURE 13. AIR BRAKE SYSTEM.

Current part is item (17) on diagram. Available at www.oshkoshequipment.com

SECTION II (1)	ITEM (2)	(3)	TM9-2330-205-14&P (4)	(5)	(6)
NO	SMR CODE	FSCM	PART NUMBER	DESCRIPTION AND USABLE ON CODE (UOC)	QTY
1208 AIR BRAKE SYSTEM					
FIG. 13. AIR BRAKE SYSTEM					
1	PAOZZ	96906	MS21333-36	CLAMP, LOOP	2
2	PAOZZ	96906	MS90727-60	SCREW, CAP, HEXAGON H	7
3	PAOZZ	96906	MS90727-74	SCREW, CAP, HEXAGON H	2
4	PAOZZ	40342	N13008	STRAP, RETAINING	4
5	PAOZZ	23705	A298748	TANK, PRESSURE	1
6	PAOZZ	96906	MS39182-6	ELBOW, PIPE TO TUBE	1
7	PAOZZ	19207	8699511	LINE, RELAY VALVE	1
8	PAOZZ	96906	MS90726-34	BOLT, MACHINE	5
9	PFOZZ	19207	7979851	BRACKET, PIPE	2
10	XDOZZ	19207	10931736	SUPPORT	1
11	PAOZZ	96906	MS51845-4	ELBOW, PIPE	2
12	PAOZZ	19207	8699512	LINE, AIR FILTER TO COUPLING TO RELAY VALVE	1
13	PAOZZ	96906	MS35333-49	WASHER, LOCK	2
14	PAOZZ	30612	24569D	NUT, PLAIN, HEXAGON	2
15	PAOZZ	16662	AC2569	ADAPTER, STRAIGHT, PI UOC: C37	2
16	PAOZZ	96906	MS39182-3	ELBOW, PIPE TO TUBE	1
17	PAOZZ	23705	A298408	HOSE ASSEMBLY, NONME	2
18	PAOZZ	96906	MS35746-1	COUPLING HALF, QUICK	1
19	PFOZZ	96906	MS39133-2-B	ADAPTER, STRAIGHT, PI	1
20	PAOZZ	19207	8699510	LINE, AIR FILTER TO RELAY VALVE	1
21	PAOZZ	96906	MS21044N6	NUT, SELF-LOCKING, HE	7
22	PAOZZ	96906	MS35338-46	WASHER, LOCK	2
23	PAOZZ	96906	MS51968-8	NUT, PLAIN, HEXAGON	2
24	PAOZZ	96906	MS35782-5	COCK, DRAIN	1
25	PAOZZ	96906	MS39179-9	ADAPTER, STRAIGHT, PI RELAY VALVE TO RESERVOIR	1
26	PAOZZ	19207	8699513	LINE, RELAY VALVE TO AIR CHAMBER	1
27	PAOZZ	40342	N3550	BRACKET, MOUNTING	1
28	PAOZZ	96906	MS21044N5	NUT, SELF-LOCKING, HE	5
29	PAOZZ	40342	8330281	NIPPLE, PIPE	2

END OF FIGURE

Current part is item (17) on diagram. Available at www.oshkoshequipment.com